

20	2	Patte de B.I.	185019
19	7	Rondelle Grower Ø12	9908069
18	7	Ecrou HØ12	9900215
17	7	Vis HØ12x45/30	9962081
16	2	Vis HØ16x30/30	9961915
15	2	Rondelle MNØ14	9908014
14	2	Rondelle Grower Ø20	9908067
13	2	Ecrou HØ14	9900216
12	2	Vis H14x50/34	9962031
11	1	Potence	081051
10	1	Bâti commun CM7	582249
9	1	Axe supérieur + goup. clip	144101
8	2	Goupille Anneau Ø10 + Lien	075568
7	7	Ens. Dent 32x10 + Soc (Boulon CC Ø10x40 (Soc nu Lg 190	910034 923010 910033)
6	7	Bride 50x6	910035
5	2	Ecrou HØ20	9900225
4	2	Rondelle Grower Ø14	9908072
3	2	Vis HØ20x55/55 Cl.8.8	9962057
2	1	Renfort potence CM7	080834
1	2	Axe de B.I. complet	080307
REP.	NB.	DESIGNATION	Réf.

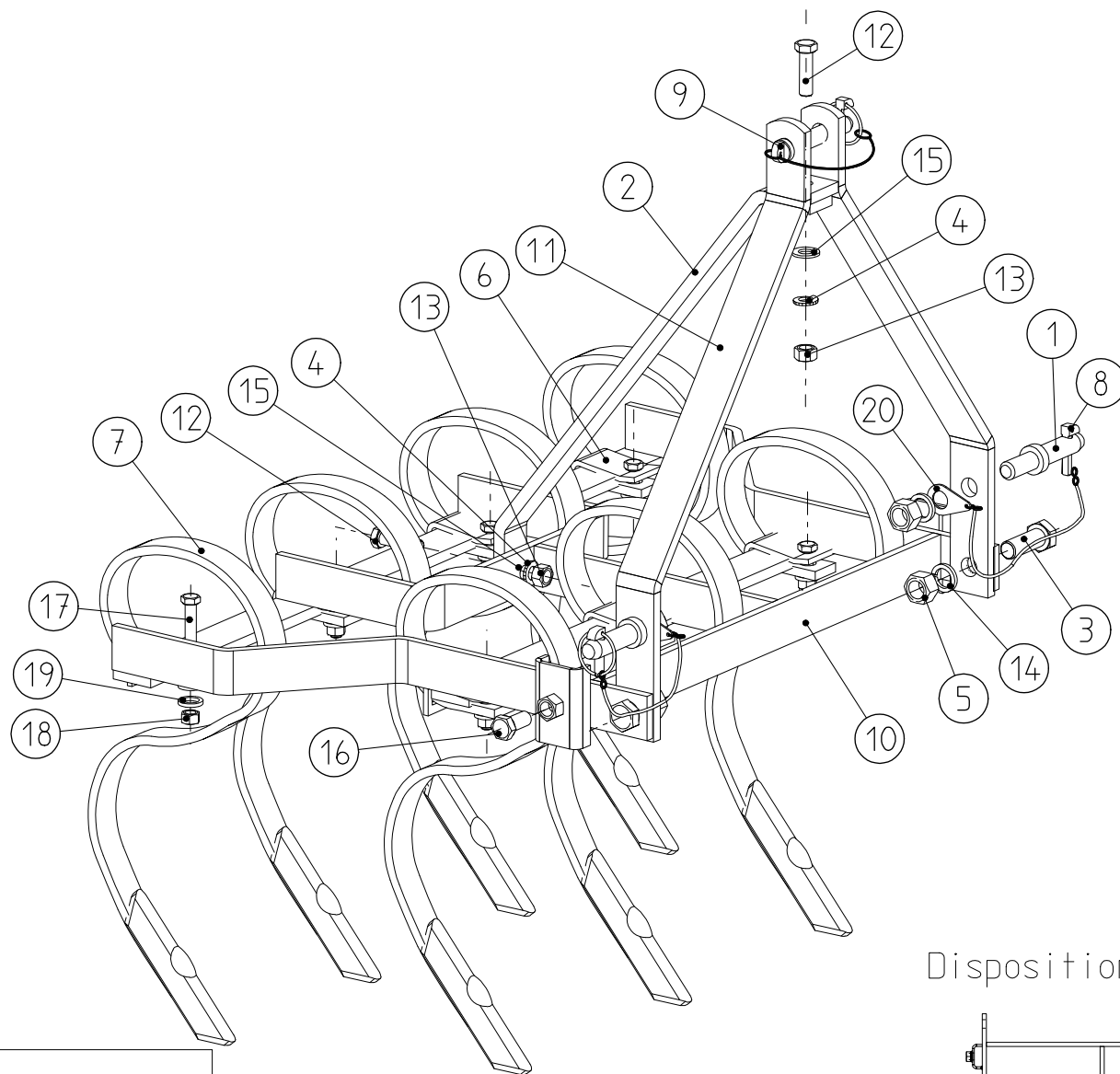

Disposition des dents

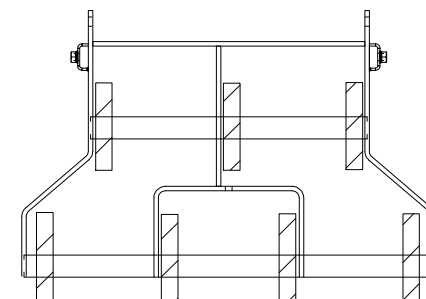

## CULTIVATEUR MICRO 7 DTS SOUPLES

# CM7

04/2007



MAJAR  
RTE MONTREAL  
11850 CARCASSONNE

Tel. 04 68 25 38 16

Fax. 04 68 72 51 61